

## INTEGRATED GREASE SEPARATOR

For animal and vegetable oils, fats and greases

### PRODUCT DESCRIPTION

**ESEP** HDPE "integrated grease separator" for animal and vegetable oils, fats and greases, with integrated sludge trap, **series PE.VI 4000 BG** (for placement above ground), in a frost free location, i.e. in basements. **Capacities 2, 4, 7 and 10 l/s**. Cover closes using star knobs with rubber seal. HDPE is especially resistant to waste water contaminated with fatty acids (no corrosion).

### APPLICATIONS

Grease separators and sludge traps are widely used in areas where professional preparation of food takes place, and other companies where greases and oils of vegetable or animal origin may contaminate the water effluent, e.g.:

- Hotels
- Restaurants
- Canteens
- Elderly centres
- Hospitals
- Butcheries
- Soap and stearine factories
- Oil mills

### QUALITY

- Capacity determined, dimensioned and tested in accordance with NEN-EN 1825 - BRL 5252.
- HDPE is especially resistant to waste water contaminated with fatty acids (no corrosion).
- Suitable for placement above ground (frost free).
- CE certified.

### DRAWING

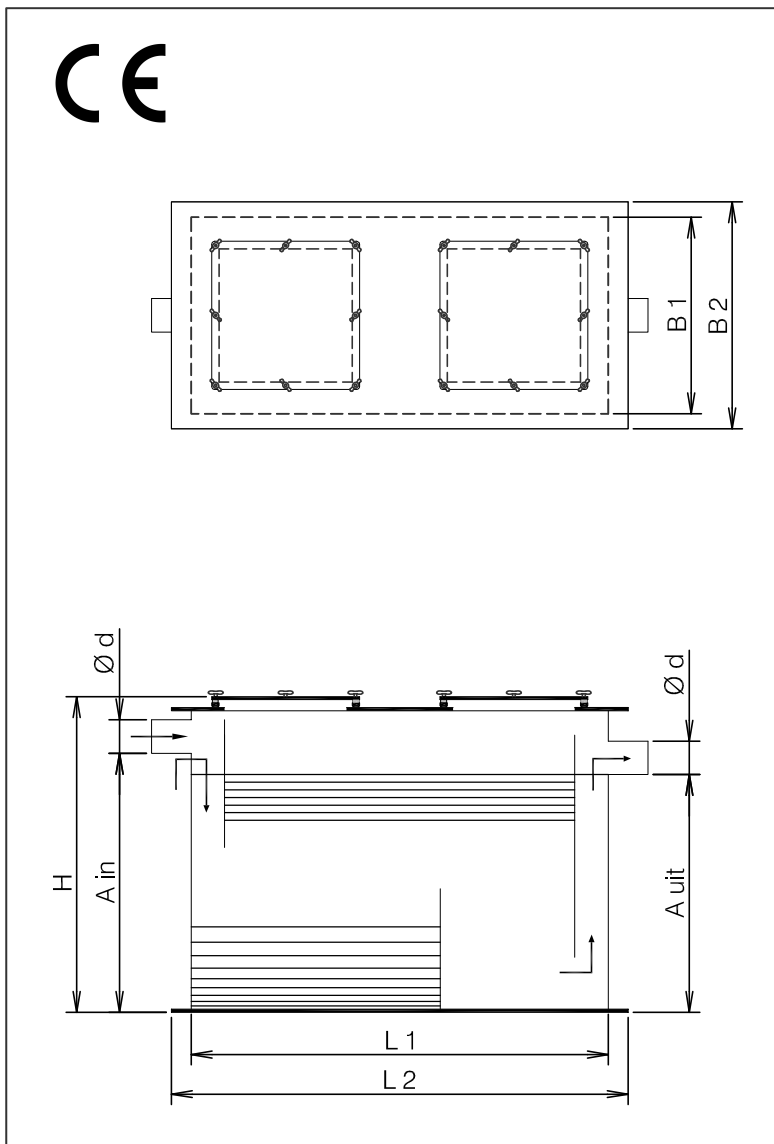

### SPECIFICATIONS

Type	I/s	I*	O*	Ø d	L 1	L 2	B 1	B 2	H	A in	A uit	Dks.	Kg.
PE.VI 4002 BG	2	200	125	110	1380	1500	620	750	1050	850	770	2	200
PE.VI 4004 BG	4	400	175	110	1880	2000	850	1000	1050	850	770	2	235
PE.VI 4007 BG	7	700	665	160	1980	2060	1015	1055	1550	1300	1230	2	500
PE.VI 4010 BG	10	1000	850	160	2960	3000	1005	1045	1550	1300	1230	3	700

I\* = Volume of the sludge trap (litres).  
O\* = Oil/grease storage volume (litres).

For determining and calculating the nominal separator size feel free to contact us for support according to the European norm EN-1825

\*\* N.B. Maximum level of ground covering 500 mm. When high ground water, intensive heavy traffic or deeper placement is present, extra precautions have to be made. Factory warranty on water tightness up to the usual aquiferous range.

dimensions in mm – subject to change – all rights reserved

02-2016-02-PE.VI 4000 BG 2-10 EN