

INTEGRATED OIL SEPARATOR PA

For light mineral liquids (e.g. oil and petrol)

PRODUCT DESCRIPTION

ESEP concrete prefabricated "PA-certified integrated oil separator" for light mineral fluids with integrated sludge trap, **series PA-KMI 6000, capacity 3, 6 or 10 l/s**. Resistant against mineral liquids by means of internal surface treatment using a watertight concrete layer followed by two-component epoxy coating. Equipped with HDPE odour trap on the inlet side and HDPE automatic closure device on the outlet side. Manhole cover in full cast iron or a cast iron-concrete combination.

APPLICATIONS

Oil and sludge separators are frequently used when light liquids (e.g. oil and petrol) might be released into the water flow, for example in:

- Automotive companies
- Engine overhauling
- Petrol stations
- Car washes
- Industrial areas
- Parking lots
- Storage areas
- Environmental parks
- Unloading zones

QUALITY

- Provided with internal acid- and oil resistant two-component epoxy coating
- Capacity determined, dimensioned and tested according to NEN-EN 858
- With HDPE odour trap on the inlet side and HDPE automatic closure device on the outlet side, certificate no. PA-4950177-01
- Concrete quality in accordance with NEN-EN 206-1 and NEN-EN 8005, minimal C35/45 environmental classification XA3
- CE certified

Manhole cover:

- Cast iron-concrete combination conform NEN-EN 124 class B 125 kN
- or class D 400 kN wheel pressure

DRAWING

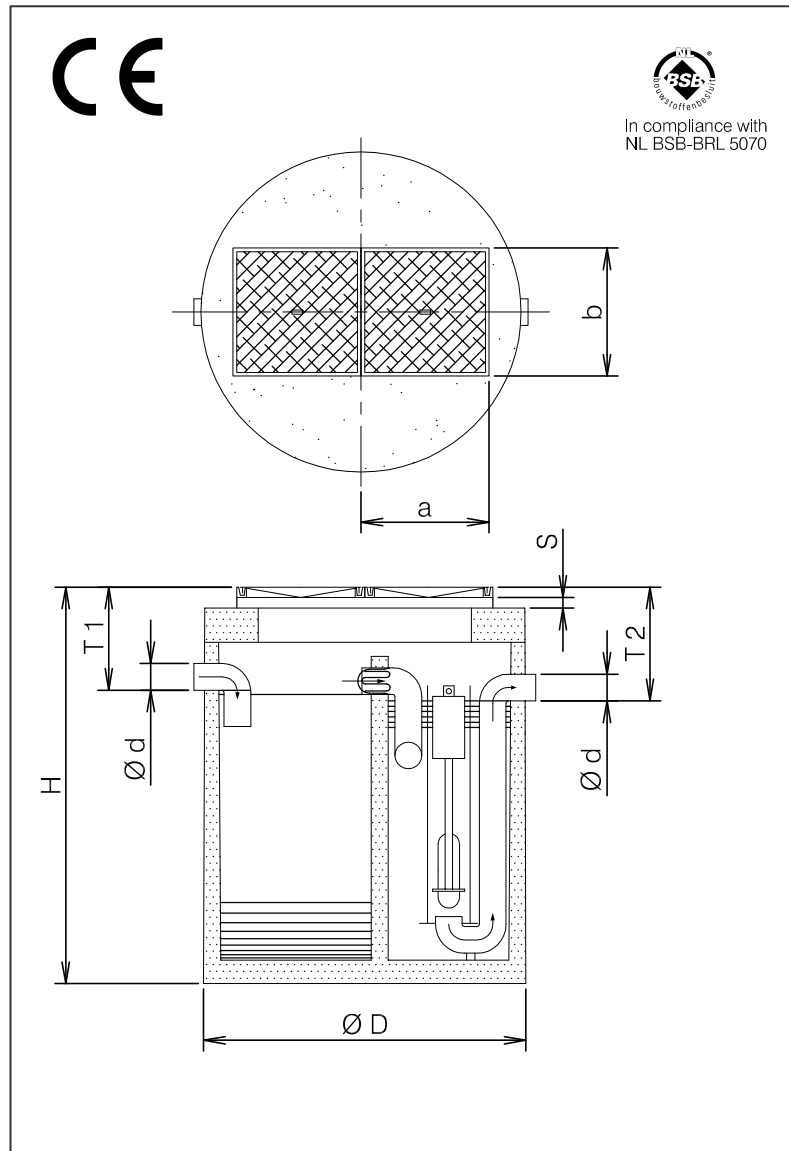

SPECIFICATIONS

Type	l/s	I*	O*	Ø D	Ø d	H	T 1	T 2	a	b	Covers	Kg.
PA-KMI 6003	3	700	165	1510	125	1840	435	485	600	600	2	2200
PA-KMI 6006	6	1370	120	1700	125	1830	490	540	600	600	2	2600
PA-KMI 6206	6	2950	155	2220	125	1880	420	470	600	600	2	4800
PA-KMI 6010	10	2540	205	2220	160	1880	420	470	600	600	2	4800
In case of cover class D 400 kN**						+70	+70	+70				

I* = Volume of the sludge trap (litres).

O* = Oil storage volume (litres).

S = Adjustable height by using concrete extension rings.

Available in heights 100, 200, 300 and 500 mm. To be installed watertight on-site.

** N.B. Maximum level of ground covering 500 mm. When high groundwater level, intensive heavy traffic, or deeper placement is present, extra precautions have to be made. Factory warranty on water tightness up to the usual aquiferous range.

dimensions in mm – subject to change – all rights reserved

01-2015-10-PA-KMI 6000 3-10 EN