

## SEPARATE OIL SEPARATOR PA

For light mineral liquids (e.g. oil and petrol)

### PRODUCT DESCRIPTION

**ESEP** concrete prefabricated **"PA-certified integrated oil separator"** for light mineral fluids with integrated sludge trap, **series PA-KMI 6000, capacity 10, 15, 20 or 30 l/s**. Resistant against mineral liquids by means of internal surface treatment using a watertight concrete layer followed by two-component epoxy coating. Equipped with HDPE odour trap on the inlet side and HDPE automatic closure device on the outlet side. Manhole cover in full cast iron or a cast iron-concrete combination.

### APPLICATIONS

Oil and sludge separators are frequently used when light liquids (e.g. oil and petrol) might be released into the water flow, for example in:

- Automotive companies
- Engine overhauling
- Petrol stations
- Car washes
- Industrial areas
- Parking lots
- Storage areas
- Environmental parks
- Unloading zones

### QUALITY

- Provided with internal acid- and oil resistant two-component epoxy coating
- Capacity determined, dimensioned and tested according to NEN-EN 858
- With HDPE odour trap on the inlet side and HDPE automatic closure device on the outlet side, certificate no. PA-4950177-01
- Concrete quality in accordance with NEN-EN 206-1 and NEN-EN 8005, minimal C35/45 environmental classification XC2
- CE certified

Manhole cover:

- Cast iron-concrete combination conform NEN-EN 124 class B 125 kN
- or class D 400 kN wheel pressure

### DRAWING

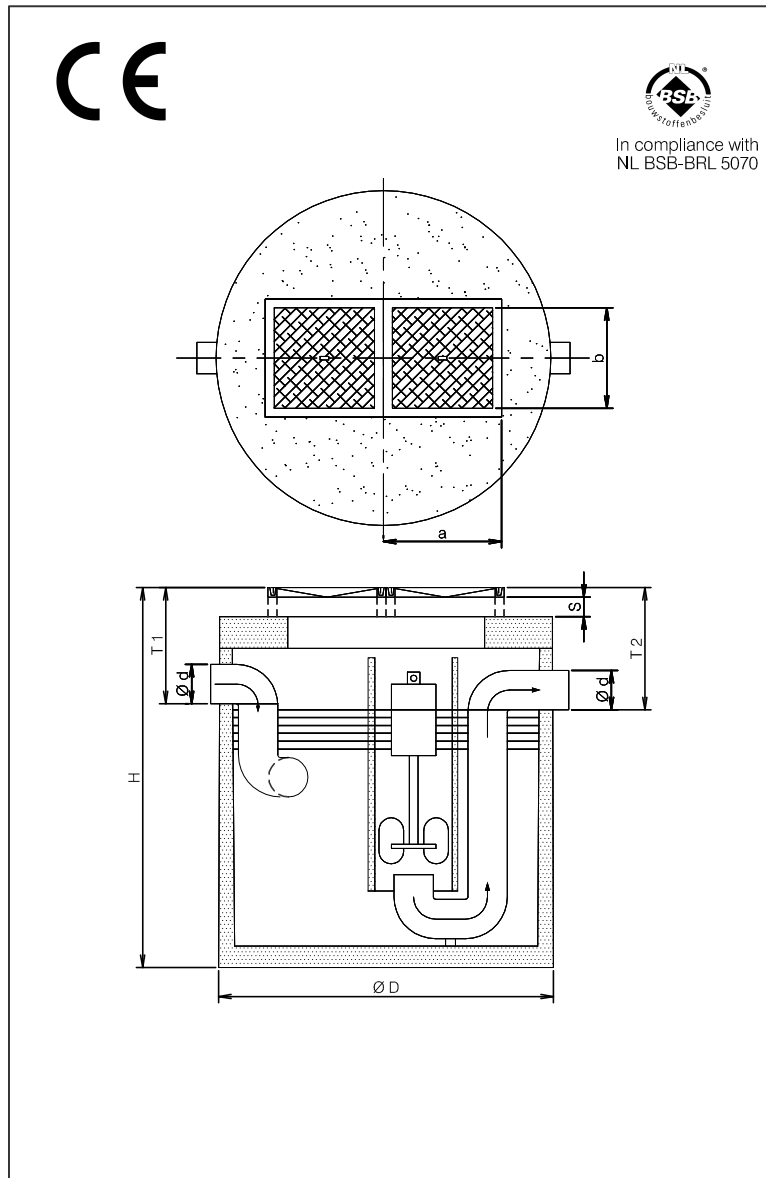

### SPECIFICATIONS

Type	l/s	O*	Ø D	Ø d	H	T 1	T 2	a	b	Covers	Kg.
PA-KM 5010	10	235	1510	160	1820	435	465	600	600	2	2100
PA-KM 5015	15	300	1700	200	1850	490	520	600	600	2	2350
PA-KM 5020	20	515	2220	200	1870	420	450	600	600	2	4250
PA-KM 5030	30	565	2350	250	2210	500	530	600	600	2	5500
In case of cover class D 400 kN**					+70	+70	+70				

O\* = Oil storage volume (litres).

S = Adjustable height by using concrete extension rings.

Available in heights 100, 200, 300 and 500 mm. To be installed watertight on-site.

\*\* N.B. Maximum level of ground covering 500 mm. When high groundwater level, intensive heavy traffic, or deeper placement is present, extra precautions have to be made. Factory warranty on water tightness up to the usual aquiferous range.